

PART NUMBER	SIZE	"R"	"O"	"H"	"S" MIN	"B" MIN	"L"
5136820	1"	60"	17 5/8"	34"	1 7/8"	N/A	47 1/8"
5136830	1 1/4"	60"	17 5/8"	34"	2"	N/A	47 1/8"
5136850	2"	60"	17 5/8"	34"	2"	N/A	47 1/8"
5136860	2 1/2"	60"	17 5/8"	34"	3"	N/A	47 1/8"
5136810	3"	60"	17 5/8"	34"	3 1/8"	N/A	47 1/8"
5121122	4"	60"	17 5/8"	34"	3 3/8"	N/A	47 1/8"
5136880	5"	60"	17 5/8"	34"	3 5/8"	N/A	47 1/8"
5121117	6"	60"	17 5/8"	34"	3 3/4"	N/A	47 1/8"

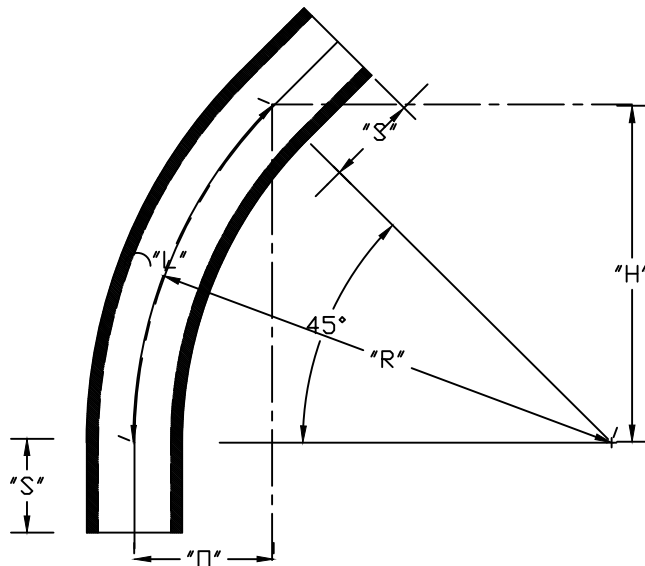

ETL LISTED  
 CONFORMS TO UL651  
 ETL CONTROL #3107144  
 CONFORMS TO NEMA TC3  
 SEE NEC ARTICLE 352 FOR USE  
 MATERIAL IS RIGID PVC  
 BEND TOLERANCE IS  $\pm 2^\circ$



**CANTEX**  
 INC.  
 Fort Worth, TEXAS

45° Elbows, Plain End  
 Schedule 80 60" Radius Elbows

Drawn By: O.M.

Date: 5/12/17

Ref. 5136850